



Property Details

Select Feature(s) in the map

2110 RIVER RD

Property Record Card

Owner: POWERS & ATKINS LLC
Owner2: RIVERLAND PARTNERS
Parcel Id: 100 09001 000
Land Use: RESIDENTIAL
Current Appraisal: \$29,300
Sale Date: 7/30/2021
Sale Price: \$425,000
Legal Reference: 1330191
Zoning: R-1

Building Sketch

☐ Sketch not applicable, click for property details.

Property Image

☐ Image not available, click for property details.

[Zoom to](#) [Clear Selected](#)

...



Stratum

Montgomery County TN GIS Viewer



Print

⌂ X

Layout:

MAP_ONLY

Format:

PDF

⚙ Advanced

🖨 Print

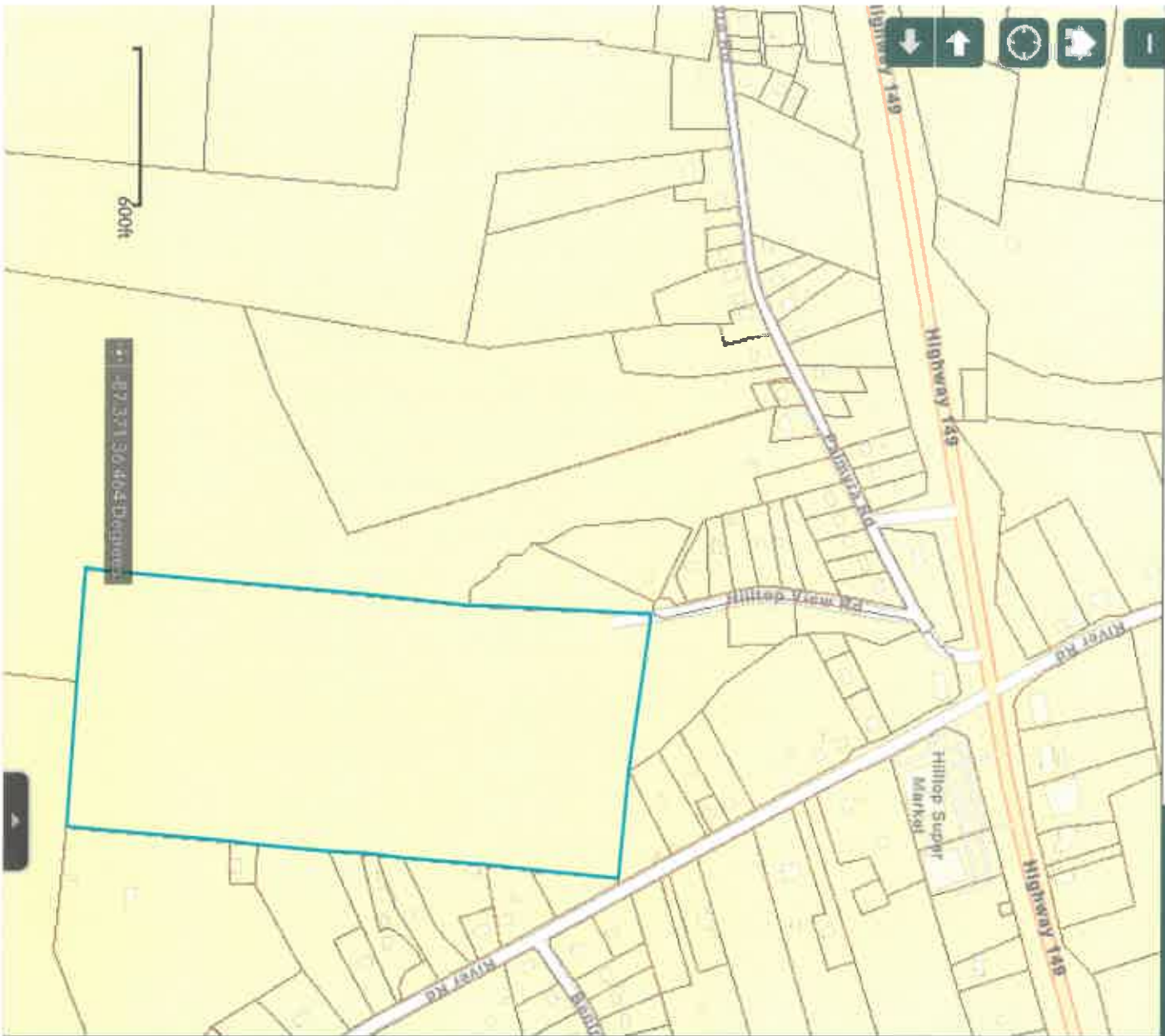

Map 160, Parcel 91