

December 20, 2017

Mr. David Jones, Chairman
c/o Sharla Dillon
Tennessee Regulatory Authority
502 Deaderick St., 4th Floor
Nashville, TN 37243



Re: Docket No. 17-00145 - Petition of Tennessee Wastewater Systems Inc
To Amend Its Certificate of Convenience and Necessity

Dear Chairman Jones:

The enclosed documents are supplemental exhibits to the above referenced Petition.

Kind regards,

Jeff Ridsen
General Counsel
Tennessee Wastewater Systems, Inc.

SWEET APPLE HILL SUBDIVISION

3538-42 BEAR CREEK RD & 4009-33 CARTERS CREEK PK

**S.T.E.P. SYSTEM DESIGN
WASTEWATER COLLECTION,
TREATMENT & DISPERSAL
WILLIAMSON COUNTY, TENNESSEE
SOP #>>>>>**

Owner: Old Hillsboro Building Co., LLC
237 2nd Ave South
Franklin, TN 37064

Developer: Eddie Miles
237 2nd Ave South
Franklin, TN 37064
(615) 500-1610

Engineer:  **TSQUARE ENGINEERING**
Consulting Civil Engineering
P.O. BOX 210645 • RICHMOND, TX 77221 • (615) 370-1443
ts@tsquareengineering.com

Surveyor: Harrah & Associates
504 Autumn Springs Ct Suite B-15,
Franklin, TN (615) 778-0863



VICINITY MAP
N.T.S.

Topographic Boundary Survey, including property lines, legal description, existing utilities, site topography with spot elevations, outstanding physical features and existing structure locations was provided by the following companies:

Harnah & Associates
904 Autumn Springs Ct Suite B-15,
Franklin, TN (615) 778-0863

Taquara Engineering and its associates will not be held responsible for its accuracy or for design errors or omissions resulting from potential survey inaccuracies.

INDEX OF SHEETS

| SHEET # | SHEET TITLE |
|----------------|---------------------------------------|
| COVER | Cover Sheet |
| C-1.0 | Site Plan |
| C-1.1 | Drip Field Setbacks |
| C-1.2 | Treatment Facility & Storage Setbacks |
| C-2.0 | Cross Section Plan |
| C-2.1 | Cross Section Profiles |
| DT-1.0- 6.0 | S.T.E.P Details |
| L-1.0 | Landscaping Plan |

LAND DATA

Existing Zoning - RP-5
621.83 acres

Deed References

Deed Book 2301 Page 378
Map 103, Parcels 14.00
268.71 acres

Deed Book 2303 Page 469
Map 103, Parcels 9.00
351.12 acres

STEP System Data

Design Flow = 36,000 gpd
Land Application Area Required = 4.13 Ac.
Land Application Area Provided = 4.13 Ac.
Land Reserve Area Provided = 4.24 Ac.
Total Area Provided = 8.37 Ac.

| DATE | REVISIONS |
|-------------|-----------|
| 12-18-2017 | |
| BY: JHONNIE | |
| CHECKED BY: | |
| DRAWN BY: | |
| TITLE: | |
| REVISED: | |
| TEST | |

BEAR CREEK ROAD
FRANKLIN, TN 37064
WILLIAMSON COUNTY, TENNESSEE

SWEET APPLE HILL SUBDIVISION

PROJECT
17-0925

SHEET
COVER

T-SQUAREENGINEERING

701 WEST MAIN ST • FRANKLIN, TN • 615-678-8212 • WWW.T2-ENG.COM

NOTES:

1. THIS PROPERTY HAS BEEN REVIEWED FOR THE EXISTENCE OF INTERMITTENT AND PERMANENT STREAMS. STREAMS THAT WOULD ACQUIRE INTERMITTENT NATURAL AREA DESIGNATION IN SECTION 4 OF THE HILLMANSON COUNTY EROSION WATER MANAGEMENT REGULATIONS HAVE BEEN LOCATED AS SHOWN WITHIN THE WATERSHED NATURAL AREA. THERE SHALL BE NO CLEARING, GRADING, CONSTRUCTION OR DISTURBANCE OF VEGETATION EXCEPT AS PERMITTED BY THE HILLMANSON COUNTY ENGINEERING DEPARTMENT.
2. THIS SITE HAS BEEN REVIEWED FOR THE PRESENCE OF STEEP SLOPES, HILLSIDES AND PROPOSED, SLOPES, HILLSIDES AND MARKET FEATURES.
3. FLOOD NOTE: THIS PROPERTY IS LOCATED IN AN AREA DESIGNATED AS A 100 YEAR FLOOD ZONE AS INDICATED ON FEMA PANEL 8 (HYDROLOGY) AND PANEL 9 (FLOOD DAMAGE PREVENTION) OF HILLMANSON COUNTY, TN, LITD 20080000.

RESOURCE PROTECTION STANDARDS

THE T-SQUARE ENGINEERING FOLLOWS THE RESOURCE PROTECTION STANDARDS SET FORTH IN ARTICLE 13 OF THE EROSION CONTROL, PROTECTION, AND RESTORATION REGULATIONS, HILLMANSON COUNTY, TENNESSEE. THESE STANDARDS ARE INTENDED TO PROTECT THE WATERSHED NATURAL AREA, WETLANDS, AND OTHER NATURAL RESOURCES. THE STANDARDS ARE INTENDED TO BE USED IN CONJUNCTION WITH THE EROSION CONTROL, PROTECTION, AND RESTORATION REGULATIONS, HILLMANSON COUNTY, TENNESSEE.

NEW 3" PVC COLLECTION MAIN
APPROXIMATE ORIENTATION OF DRIP LINES
NEW DRIP FIELD SUPPLY MAIN
NEW DRIP FIELD RETURN MAIN

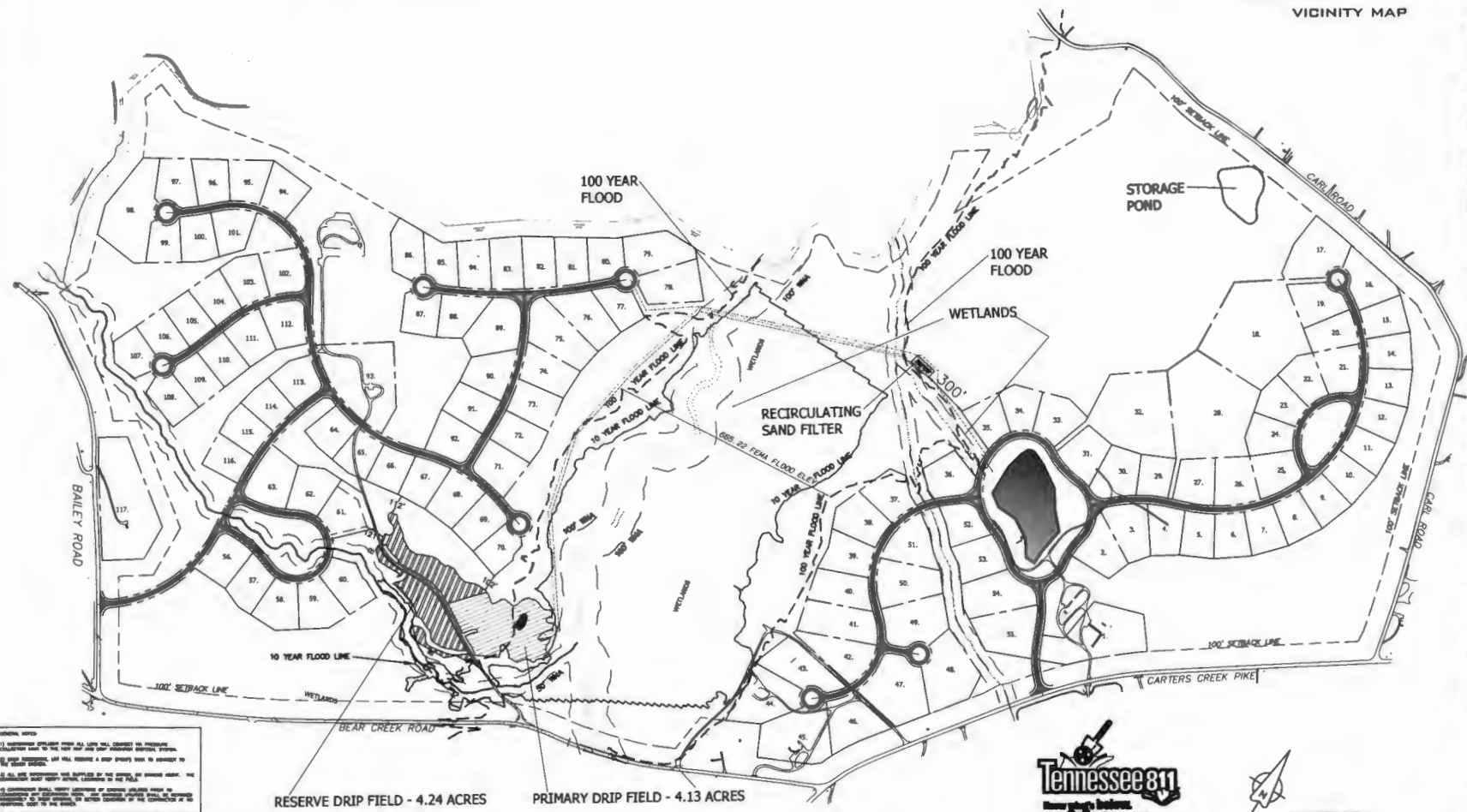

GENERAL NOTES:

1. THE PROPERTY OWNER SHALL BE RESPONSIBLE FOR OBTAINING ALL NECESSARY PERMITS FROM THE APPROPRIATE AGENCIES.
2. THE PROPERTY OWNER SHALL BE RESPONSIBLE FOR OBTAINING ALL NECESSARY PERMITS FROM THE APPROPRIATE AGENCIES.
3. THE PROPERTY OWNER SHALL BE RESPONSIBLE FOR OBTAINING ALL NECESSARY PERMITS FROM THE APPROPRIATE AGENCIES.
4. THE PROPERTY OWNER SHALL BE RESPONSIBLE FOR OBTAINING ALL NECESSARY PERMITS FROM THE APPROPRIATE AGENCIES.
5. THE PROPERTY OWNER SHALL BE RESPONSIBLE FOR OBTAINING ALL NECESSARY PERMITS FROM THE APPROPRIATE AGENCIES.
6. THE PROPERTY OWNER SHALL BE RESPONSIBLE FOR OBTAINING ALL NECESSARY PERMITS FROM THE APPROPRIATE AGENCIES.
7. THE PROPERTY OWNER SHALL BE RESPONSIBLE FOR OBTAINING ALL NECESSARY PERMITS FROM THE APPROPRIATE AGENCIES.
8. THE PROPERTY OWNER SHALL BE RESPONSIBLE FOR OBTAINING ALL NECESSARY PERMITS FROM THE APPROPRIATE AGENCIES.
9. THE PROPERTY OWNER SHALL BE RESPONSIBLE FOR OBTAINING ALL NECESSARY PERMITS FROM THE APPROPRIATE AGENCIES.
10. THE PROPERTY OWNER SHALL BE RESPONSIBLE FOR OBTAINING ALL NECESSARY PERMITS FROM THE APPROPRIATE AGENCIES.

RESERVE DRIP FIELD - 4.24 ACRES
PRIMARY DRIP FIELD - 4.13 ACRES



| REVISIONS | | | |
|---|------------|----------|----------|
| NO. | DATE | BY | REVISION |
| 1 | 12-18-2017 | AS SHOWN | AS SHOWN |
| 2 | | T-SQUARE | REVIEWER |
| 3 | | YET | |
| SITE PLAN BEAR CREEK ROAD FRANKLIN, TN 37064 WILLIAMSON COUNTY, TENNESSEE | | | |
| SWEET APPLE HILL SUBDIVISION | | | |
| PROJECT 17-0925 | | | |
| SHEET G-T-10 | | | |

T-SQUARE ENGINEERING

701 WEST MAIN ST • FRANKLIN, TN • 615-678-8212 • WWW.T2-ENG.COM

STATE OF TENNESSEE

COUNTY OF Rutherford

We the undersigned Charles R. Hyatt
and _____
of Tennessee Wastewater Systems, Inc.

on our oath do severally say that the foregoing return has been prepared,
under our direction, from the original books, papers and records of said
utility; that we have carefully examined the same, and declare the same to be
a correct statement of the business and affairs of said utility for the period
covered by the return in respect to each and every matter and thing therein
set forth, to the best of our knowledge, information and belief.

Charles R. Hyatt
(Chief Officer)

CRH
(Officer in charge of accounts)

Subscribed and sworn to before me this...
day of February 3, 2017
Notary Public Susan R. Chafin
My commission will expire 02/20/2018
(Seal)



TABLE OF CONTENTS

| | | | |
|----|--|-----|----|
| 1 | | | 1 |
| 2 | | | 2 |
| 3 | | | 3 |
| 4 | AFFIDAVIT - First page of this Report | | 4 |
| 5 | FINANCIAL SECTION | | 5 |
| 6 | Identification and ownership..... | F-2 | 6 |
| 7 | Officers & Managers..... | F-2 | 7 |
| 8 | Income Statement..... | F-3 | 8 |
| 9 | Comparative Balance Sheet..... | F-4 | 9 |
| 10 | Net Utility Plant..... | F-5 | 10 |
| 11 | Accumulated Depreciation & Amortization of Utility Plant..... | F-5 | 11 |
| 12 | Capital Stock..... | F-6 | 12 |
| 13 | Retained Earnings..... | F-6 | 13 |
| 14 | Proprietary Capital..... | F-6 | 14 |
| 15 | Long-Term Debt..... | F-6 | 15 |
| 16 | Taxes Accrued..... | F-7 | 16 |
| 17 | Payments For Services Rendered By Other Than Employees..... | F-7 | 17 |
| 18 | Contributions In Aid Of Construction..... | F-8 | 18 |
| 19 | Additions To Contributions In Aid Of Construction (Credits)..... | F-8 | 19 |
| 20 | | | 20 |
| 21 | | | 21 |
| 22 | | | 22 |
| 23 | | | 23 |
| 24 | | | 24 |
| 25 | | | 25 |
| 26 | | | 26 |
| 27 | | | 27 |
| 28 | | | 28 |
| 29 | | | 29 |
| 30 | | | 30 |
| 31 | | | 31 |
| 32 | | | 32 |
| 33 | | | 33 |
| 34 | | | 34 |
| 35 | | | 35 |
| 36 | | | 36 |
| 37 | | | 37 |
| 38 | | | 38 |
| 39 | | | 39 |
| 40 | | | 40 |
| 41 | | | 41 |
| 42 | | | 42 |
| 43 | | | 43 |
| 44 | | | 44 |
| 45 | | | 45 |
| 46 | | | 46 |
| 47 | | | 47 |
| 48 | | | 48 |
| 49 | | | 49 |
| 50 | | | 50 |
| 51 | | | 51 |
| 52 | | | 52 |
| 53 | | | 53 |
| 54 | | | 54 |
| 55 | | | 55 |
| 56 | | | 56 |
| 57 | | | 57 |
| 58 | | | 58 |
| 59 | | | 59 |
| 60 | | | 60 |
| 61 | | | 61 |
| 62 | | | 62 |

WATER SECTION

| | |
|---|-----|
| Water Utility Plant Accounts..... | W-1 |
| Analysis Of Accumulated Depreciation By Primary Account.. | W-2 |
| Water Operation & Maintenance Expense..... | W-3 |
| Water Customers..... | W-3 |
| Pumping & Purchased Water Statistics..... | W-4 |
| Sales For Resale..... | W-4 |
| Wells & Well Pumps..... | W-5 |
| Reservoirs..... | W-5 |
| High Service Pumping..... | W-5 |
| Source Of Supply..... | W-6 |
| Water Treatment Facilities..... | W-6 |
| Other Water System Information..... | W-6 |

SEWER SECTION

| | |
|---|-----|
| Sewer Utility Plant Accounts..... | S-1 |
| Analysis Of Accumulated Depreciation By Primary Account.. | S-2 |
| Sewer Operation & Maintenance Expense..... | S-3 |
| Sewer Customers..... | S-3 |
| Pumping Equipment..... | S-4 |
| Service Connections..... | S-4 |
| Collecting Mains, Force Mains, & Manholes..... | S-4 |
| Treatment Plant..... | S-5 |
| Master Lift Station Pumps..... | S-5 |
| Other Sewer System Information..... | S-5 |

SUPPLEMENTAL FINANCIAL DATA

| | |
|------------------------------------|------|
| Rate Base..... | SU-1 |
| Adjusted Net Operating Income..... | SU-1 |

IDENTIFICATION & OWNERSHIP

Report of: Tennessee Wastewater Systems, Inc.
(REPORT THE EXACT NAME OF UTILITY)

Located at: 851 Aviation Parkway Year Ended: 41638
Smyrna, TN 37167

Date Utility was Originally Organized:
3/22/1993

Location of Office Where Accounts and Records are Kept:
851 Aviation Parkway, Smyrna TN 37167

Give the Name, Title, & Office Address of the Officer of the Utility to Whom Correspondence Should be Addressed Con
Charles Hyatt - President Telephone: 615-220-7200
851 Aviation Parkway, Smyrna TN 37167

OFFICERS & MANAGERS

| NAME | TITLE | SALARY |
|---------------------|----------------|--------|
| Charles Hyatt | President | 0 |
| Charles Pickney Jr. | Vice President | 0 |
| Robert Pickney | Vice President | 0 |
| William Pickney | Secretary | 0 |
| Thomas Pickney | Treasurer | 0 |
| | | |
| | | |
| | | |
| | | |

OWNERSHIP

Report every corporation or individual owning or holding directly or indirectly 5 percent or more of the voting securities of the reporting utility.

[illegible]

| | | | |
|---|--|---|--------------------------------|
| Name of Respondent Tennessee Wastewater Systems, Inc. | This Report Is: (1) <u>X</u> An Original (2) A Resubmission | Date of Report (Mo, Da, Yr) 2/3/2017 | Year of Report 41273 |
|---|--|---|--------------------------------|

INCOME STATEMENT

| Account Name (a) | Ref Page (b) | Water (c) | Sewer (d) | Other (e) | Total (f) |
|---------------------------------------|--------------------|--------------|------------------|--------------|------------------|
| Gross Revenue: | | | | | |
| Residential | | - | 1,686,408 | - | 1,686,408 |
| Commercial | | - | - | - | - |
| Industrial | | - | - | - | - |
| Multi-Family | | - | - | - | - |
| Empty Lot Fees | | - | 198,628 | - | 198,628 |
| Other (Please Specify) | | - | - | - | - |
| Other (Please Specify) | | - | - | - | - |
| Other (Please Specify) | | - | - | - | - |
| Total Gross Revenue | | - | 1,885,036 | - | 1,885,036 |
| Operation & Maint. Expense | W3/S3 | - | 1,735,635 | - | 1,735,635 |
| Depreciation Expense | F-5 | - | 111,639 | - | 111,639 |
| Amortization Expense | | - | - | - | - |
| Interest Expense | | - | 13,238 | - | 13,238 |
| Other Expense (Please Specify) | | - | - | - | - |
| Taxes Other Than Income | F-7 | - | 156,129 | - | 156,129 |
| Income Taxes | F-7 | - | - | - | - |
| Total Operating Expenses | | - | 2,016,641 | - | 2,016,641 |
| Net Operating Income | | - | (131,605) | - | (131,605) |
| Other Income: | | | | | |
| Nonutility Income | | - | 151,030 | - | 151,030 |
| Grain Revenue | | - | 3,655 | - | 3,655 |
| Other (Please Specify) | | - | - | - | - |
| Other (Please Specify) | | - | - | - | - |
| Other (Please Specify) | | - | - | - | - |
| Total Other Income | | - | 154,685 | - | 154,685 |
| Other Deductions: | | | | | |
| Misc. Nonutility Expenses | | - | 29,250 | - | 29,250 |
| Other (Please Specify) | | - | - | - | - |
| Other (Please Specify) | | - | - | - | - |
| Other (Please Specify) | | - | - | - | - |
| Other (Please Specify) | | - | - | - | - |
| Total Other Deductions | | - | 29,250 | - | 29,250 |
| Net Income | | - | (6,170) | - | (6,170) |

| | | | |
|------------------------------------|--------------------------|-----------------------|-----------------------|
| Name of Respondent | This Report is: | Date of Report | Year of Report |
| Tennessee Wastewater Systems, Inc. | (1) <u>X</u> An Original | (Mo, Da, Yr) | |
| | (2) A Resubmission | 2/3/2017 | 41273 |

COMPARATIVE BALANCE SHEET

| Account Name (a) | Ref Page (b) | Current Year (c) | Previous Year (d) |
|--|--------------------|---------------------|----------------------|
| ASSETS | | | |
| Utility Plant in Service (101-105) | F5/W1/S1 | 23,057,126 | 21,806,729 |
| Accum. Depreciation and Amortization (108) | F5/W2/S2 | 7,892,199 | 7,083,310 |
| Net Utility Plant | | 15,164,927 | 14,723,419 |
| Cash | | 291,287 | 303,904 |
| Customer Accounts Receivable (141) | | 577,578 | 597,277 |
| Accrued Assets | | 16,055 | 15,915 |
| Inventory | | 109,785 | 0 |
| Other Assets (Please Specify) | | 0 | 0 |
| Other Assets (Please Specify) | | 0 | 0 |
| Total Assets | | 16,159,632 | 15,640,515 |
| LIABILITIES AND CAPITAL | | | |
| Common Stock Issued (201) | F-6 | 1,000 | 1,000 |
| Preferred Stock Issued (204) | F-6 | 0 | 0 |
| Other Paid-In Capital (211) | | 0 | 0 |
| Retained Earnings (215) | F-6 | 346,557 | 352,728 |
| Capital (Proprietary & Partnership-218) | F-6 | 0 | 0 |
| Total Capital | | 347,557 | 353,728 |
| Long-Term Debt (224) | F-6 | 0 | 0 |
| Accounts Payable (231) | | 225,467 | 111,836 |
| Notes Payable (232) | | 225,686 | 212,690 |
| Customer Deposits (235) | | 0 | 0 |
| Accrued Taxes (236) | | 0 | 48,000 |
| Reserves | | 38,947 | 426,636 |
| Intercompany | | 414,910 | 18,589 |
| Payroll Accruals | | 532 | 1,327 |
| Other Liabilities (Please Specify) | | 0 | 0 |
| Other Liabilities (Please Specify) | | 0 | 0 |
| Advances for Construction | | 0 | 0 |
| Contributions In Aid Of Const.-Net (271-2) | F-8 | 14,906,533 | 14,467,709 |
| Total Liabilities | | 15,812,075 | 15,286,787 |
| Total Liabilities & Capital | | 16,159,632 | 15,640,515 |

| | | | |
|------------------------------------|--------------------------|----------------|----------------|
| Name of Respondent | This Report is: | Date of Report | Year of Report |
| Tennessee Wastewater Systems, Inc. | (1) <u>X</u> An Original | (Mo, Da, Yr) | |
| | (2) A Resubmission | 2/3/2017 | 41273 |

NET UTILITY PLANT

| Plant Accounts (101-107) Inclusive (a) | Water (c) | Sewer (d) | Other (e) | Total (f) |
|---|--------------|-------------------|--------------|-------------------|
| Utility Plant in Service (101) | 0 | 23,057,126 | 0 | 23,057,126 |
| Construction Work in Progress (105) | 0 | 0 | 0 | 0 |
| Other (Please Specify) | 0 | 0 | 0 | 0 |
| Other (Please Specify) | 0 | 0 | 0 | 0 |
| Other (Please Specify) | 0 | 0 | 0 | 0 |
| Other (Please Specify) | 0 | 0 | 0 | 0 |
| Other (Please Specify) | 0 | 0 | 0 | 0 |
| Other (Please Specify) | 0 | 0 | 0 | 0 |
| Total Utility Plant | 0 | 23,057,126 | 0 | 23,057,126 |

ACCUMULATED DEPRECIATION AND AMORTIZATION OF UTILITY PLANT

| Account 108 (a) | Water (c) | Sewer (d) | Other (e) | Total (f) |
|--|--------------|----------------|--------------|----------------|
| Balance First of Year | 0 | 7,083,310 | 0 | 7,083,310 |
| Credits During Year: | | | | |
| Accruals charged to Depreciation Account | 0 | 111,639 | 0 | 111,639 |
| Salvage | 0 | 0 | 0 | 0 |
| Other Credits (Please Specify): | 0 | 697,250 | 0 | 697,250 |
| Other Credits (Please Specify): | 0 | 0 | 0 | 0 |
| Other Credits (Please Specify): | 0 | 0 | 0 | 0 |
| Other Credits (Please Specify): | 0 | 0 | 0 | 0 |
| Total Credits | 0 | 808,889 | 0 | 808,889 |
| Debits During Year: | | | | |
| Book/Historical Cost of Plant Retired | 0 | 0 | 0 | 0 |
| Cost of Removal | 0 | 0 | 0 | 0 |
| Other Debits (Please Specify): | 0 | 0 | 0 | 0 |
| Other Debits (Please Specify): | 0 | 0 | 0 | 0 |
| Other Debits (Please Specify): | 0 | 0 | 0 | 0 |
| Other Debits (Please Specify): | 0 | 0 | 0 | 0 |
| Total Debits | 0 | 0 | 0 | 0 |
| Balance End of Year | 0 | 7,892,199 | 0 | 7,892,199 |

| | | | |
|---|--|---|--------------------------------|
| Name of Respondent Tennessee Wastewater Systems, Inc. | This Report is: (1) <u>X</u> An Original (2) A Resubmission | Date of Report (Mo, Da, Yr) 2/3/2017 | Year of Report 41273 |
| CAPITAL STOCK (201 - 204) | | | |
| (a) | Common Stock (b) | Preferred Stock (c) | |
| Par or stated value per share | 1 | - | |
| Shares Authorized | - | - | |
| Shares issued and outstanding | 1,000 | - | |
| Total par value of stock issued | 1,000 | - | |
| Dividends declared per share for year | 0 | 0 | |
| RETAINED EARNINGS (215) | | | |
| (a) | Appropriated (b) | Unappropriated (c) | |
| Balance first of year | - | 352,728 | |
| Changes during year NET INCOME/(NET LOSS) | - | (6,171) | |
| Changes during year (Please Specify) | - | | |
| Changes during year (Please Specify) | - | - | |
| Changes during year (Please Specify) | - | - | |
| Changes during year (Please Specify) | - | - | |
| Changes during year (Please Specify) | - | - | |
| Balance end of year | 0 | 346,557 | |
| PROPRIETARY CAPITAL (218) | | | |
| (a) NONE | Proprietor (b) | Partner (c) | |
| Balance first of year | - | - | |
| Changes during year (Please Specify) | - | - | |
| Changes during year (Please Specify) | - | - | |
| Changes during year (Please Specify) | - | - | |
| Changes during year (Please Specify) | - | - | |
| Changes during year (Please Specify) | - | - | |
| Changes during year (Please Specify) | - | - | |
| Balance end of year | 0 | 0 | |
| LONG-TERM DEBT (224) | | | |
| obligation including Issue & Maturity Dates | NONE | Interest Rate (b) | Year End Balance (c) |
| Debt #1 | | 0.00% | - |
| Debt #2 | | 0.00% | - |
| Debt #3 | | 0.00% | - |
| Debt #4 | | 0.00% | - |
| Debt #5 | | 0.00% | - |
| Debt #6 | | 0.00% | - |
| Debt #7 | | 0.00% | - |
| Debt #8 | | 0.00% | - |
| Debt #9 | | 0.00% | - |
| Debt #10 | | 0.00% | - |
| Debt #11 | | 0.00% | - |
| Debt #12 | | 0.00% | - |
| Total Long-Term Debt | | | 0 |

| | | | |
|---|--|---|--------------------------------|
| Name of Respondent Tennessee Wastewater Systems, Inc. | This Report Is: (1) <input checked="" type="checkbox"/> An Original (2) <input type="checkbox"/> A Resubmission | Date of Report (Mo, Da, Yr) 2/3/2017 | Year of Report 41273 |
|---|--|---|--------------------------------|

TAXES ACCRUED (236)

| Description (a) | Water (b) | Sewer (c) | Other (d) | Total (e) |
|----------------------------------|----------------------------|----------------------------|----------------------------|----------------------------|
| Balance First of year | - | 48,000 | - | 48,000 |
| Accruals Charged: | | | | |
| Federal Income Tax | - | - | - | 0 |
| Local Property tax | - | - | - | 0 |
| State ad valorem tax | - | 29,933 | - | 29,933 |
| TN State Sales Tax | - | - | - | 0 |
| Regulatory Assessment Fee | - | - | - | 0 |
| Payroll Tax | - | 37,956 | - | 37,956 |
| Franchise & Excise | - | 40,240 | - | 40,240 |
| Other Taxes (Please Specify) | - | - | - | 0 |
| Total Taxes Accrued | 0 | 108,129 | 0 | 108,129 |
| Taxes Paid | | | | |
| Federal Income Tax | - | - | - | 0 |
| Local Property tax | - | - | - | 0 |
| State ad valorem tax | - | 77,933 | - | 77,933 |
| TN State Sales Tax | - | - | - | 0 |
| Regulatory assessment fee | - | - | - | 0 |
| Payroll Tax | - | 37,956 | - | 37,956 |
| Franchise & Excise | - | 40,240 | - | 40,240 |
| Other Taxes (Please Specify) | - | - | - | 0 |
| Total Taxes Paid | 0 | 156,129 | 0 | 156,129 |
| Balance End of Year | 0 | 0 | 0 | 0 |

PAYMENTS FOR SERVICES RENDERED BY OTHER THAN EMPLOYEES

Report all info concerning rate, management, construction, advertising, labor relations, or other professional services rendered to the Utility for which total payments during the year to any Corp, Ptnshp, indiv, or organization of any kind, amounted to \$500 or more.

| Name of Recipient | Amount | Description of Service |
|--------------------------------|---------------|-------------------------------|
| Site Engineering Consultants | 51,300 | Engineering Services |
| Adenus Technologies | 30,887 | Site Monitoring |
| Young's Fence | 7,725 | Site clearing |
| Bradley Arant Boulton Cummings | 5,100 | Legal Services |
| CUSI | 2,000 | Billing Software License |
| Elite Septic | 1,495 | Tank Pumping |
| Minor Escavating | 1,214 | Road Maintenance Service |
| Microbac | 578 | Lab Testing |
| | | |
| | | |
| | | |
| | | |
| | | |

| | | | |
|---|--|---|--------------------------------|
| Name of Respondent Tennessee Wastewater Systems, Inc. | This Report is: (1) <u>X</u> An Original (2) A Resubmission | Date of Report (Mo, Da, Yr) 2/3/2017 | Year of Report 41273 |
|---|--|---|--------------------------------|

CONTRIBUTIONS IN AID OF CONSTRUCTION (271)

| Description (a) | Water (b) | Sewer (c) | Total (d) |
|--|----------------------------|----------------------------|----------------------------|
| Balance First of Year | - | 21,468,377 | 21,468,377 |
| Add Credits During Year | - | 1,136,075 | 1,136,075 |
| Less Charges During Year | - | - | - |
| Balance End of Year | 0 | 22,604,452 | 22,604,452 |
| Less Accumulated Amortization | - | 7,697,919 | 7,697,919 |
| Net Contributions in Aid of Construction | 0 | 14,906,533 | 14,906,533 |

ADDITIONS TO CONTRIBUTIONS IN AID OF CONSTRUCTION DURING YEAR (CREDITS)

| Report below all developers or contractors agreements for which cash or property was received during the year (a) | Indicate "Cash" or "Property" (b) | Water (c) | Sewer (d) |
|--|--|----------------------------|----------------------------|
| Clovercroft Farms | Property | - | 546,510 |
| Clovercroft Preserve | Property | - | 589,565 |
| Contractor or Developer #3 | | - | - |
| Contractor or Developer #4 | | - | - |
| Contractor or Developer #5 | | - | - |
| Contractor or Developer #6 | | - | - |
| Contractor or Developer #7 | | - | - |
| Contractor or Developer #8 | | - | - |
| Contractor or Developer #9 | | - | - |
| Contractor or Developer #10 | | - | - |
| Contractor or Developer #11 | | - | - |
| Contractor or Developer #12 | | - | - |
| Contractor or Developer #13 | | - | - |
| Contractor or Developer #14 | | - | - |
| Contractor or Developer #15 | | - | - |
| Contractor or Developer #16 | | - | - |
| Contractor or Developer #17 | | - | - |
| Contractor or Developer #18 | | - | - |
| Contractor or Developer #19 | | - | - |
| Contractor or Developer #20 | | - | - |
| Contractor or Developer #21 | | - | - |
| Contractor or Developer #22 | | - | - |
| Contractor or Developer #23 | | - | - |
| Contractor or Developer #24 | | - | - |
| Contractor or Developer #25 | | - | - |
| Contractor or Developer #26 | | - | - |
| Contractor or Developer #27 | | - | - |
| Contractor or Developer #28 | | - | - |
| Contractor or Developer #29 | | - | - |
| Contractor or Developer #30 | | - | - |
| Total Credits During Year | | 0 | 1,136,075 |

| Name of Respondent | | This Report is: | | Date of Report | Year of Report |
|------------------------------------|---------------------------------------|---|---|--------------------------|---------------------|
| Tennessee Wastewater Systems, Inc. | | (1) <input checked="" type="checkbox"/> An Original | (2) <input type="checkbox"/> A Resubmission | (Mo, Da, Yr) 2/3/2017 | 2/3/2017 |
| SEWER UTILITY PLANT ACCOUNTS | | | | | |
| Acct No. (a) | Account Name (b) | Previous Year (c) | Additions (d) | Retirements (e) | Current Year (f) |
| 351 | Organization | - | - | - | - |
| 352 | Franchises | - | - | - | - |
| 353 | Land & Land Rights | 2,667,264 | 88,510 | - | 2,755,774 |
| 354 | Structures & Improvements | - | - | - | - |
| 360 | Collection Sewers - Force | 210,000 | - | - | 210,000 |
| 361 | Collection Sewers - Gravity | 2,371,714 | - | - | 2,371,714 |
| 362 | Special Collecting Structures | - | - | - | - |
| 363 | Services to Customers | - | - | - | - |
| 364 | Flow Measuring Devices | - | - | - | - |
| 365 | Flow Measuring Installations | - | - | - | - |
| 370 | Receiving Wells | - | - | - | - |
| 371 | Pumping Equipment | - | - | - | - |
| 380 | Treatment & Disposal Equipment | 16,262,230 | 1,047,565 | - | 17,309,795 |
| 381 | Plant Sewers | - | - | - | - |
| 382 | Outfall Sewer Lines | - | - | - | - |
| 389 | Other Plant & Miscellaneous Equipment | - | - | - | - |
| 390 | Office Furniture & Equipment | 114,533 | 33,500 | - | 148,033 |
| 391 | Transportation Equipment | 180,988 | 80,822 | - | 261,810 |
| 392 | Stores Equipment | - | - | - | - |
| 393 | Tools, Shop & Garage Equipment | - | - | - | - |
| 394 | Laboratory Equipment | - | - | - | - |
| 395 | Power Operated Equipment | - | - | - | - |
| 396 | Communication Equipment | - | - | - | - |
| 397 | Miscellaneous Equipment | - | - | - | - |
| 398 | Other Tangible Plant | - | - | - | - |
| | Total Sewer Plant | 21,388,722 | 1,160,887 | - | 22,549,609 |

| | | | |
|--|---|--|-------------------------|
| Name of Respondent Tennessee Wastewater Systems, Inc. | This Report is: (1) <u>X</u> An Original (2) A Resubmission | Date of Report (Mo, Da, Yr) 2/3/2017 | Year of Report 41273 |
|--|---|--|-------------------------|

ANALYSIS OF ACCUMULATED DEPRECIATION BY PRIMARY ACCOUNT - SEWER

| Account Number (a) | Account (b) | Average Service Life in Years (c) | Average Salvage Value in Percent (d) | Depreciation Rate Applied* (e) | Accumulated Depreciation Balance Previous Year (f) | Debits (g) | Credits (h) | Accumulated Depreciation Balance End of Year (i) |
|-----------------------|---------------------------------------|--------------------------------------|---|-----------------------------------|---|---------------|----------------|---|
| 354 | Structures & Improvements | - | 0.00% | 0.00% | - | - | - | - |
| 360 | Collection Sewers - Force | 50 | 0.00% | 0.00% | 29,411 | - | 4,200 | 33,611 |
| 361 | Collection Sewers - Gravity | 50 | 0.00% | 0.00% | 542,514 | - | 47,434 | 589,948 |
| 362 | Special Collecting Structures | - | 0.00% | 0.00% | - | - | - | - |
| 363 | Services to Customers | - | 0.00% | 0.00% | - | - | - | - |
| 364 | Flow Measuring Devices | - | 0.00% | 0.00% | - | - | - | - |
| 365 | Flow Measuring Installations | - | 0.00% | 0.00% | - | - | - | - |
| 370 | Receiving Wells | - | 0.00% | 0.00% | - | - | - | - |
| 371 | Pumping Equipment | - | 0.00% | 0.00% | - | - | - | - |
| 380 | Treatment & Disposal Equipment | 26 | 0.00% | 0.00% | 6,422,658 | - | 645,616 | 7,068,274 |
| 381 | Plant Sewers | - | 0.00% | 0.00% | - | - | - | - |
| 382 | Outfall Sewer Lines | - | 0.00% | 0.00% | - | - | - | - |
| 389 | Other Plant & Miscellaneous Equipment | - | 0.00% | 0.00% | - | - | - | - |
| 390 | Office Furniture & Equipment | 7 | 0.00% | 0.00% | 30,021 | - | 48,458 | 78,479 |
| 391 | Transportation Equipment | 5 | 0.00% | 0.00% | 58,706 | - | 63,181 | 121,887 |
| 392 | Stores Equipment | - | 0.00% | 0.00% | - | - | - | - |
| 393 | Tools, Shop & Garage Equipment | - | 0.00% | 0.00% | - | - | - | - |
| 394 | Laboratory Equipment | - | 0.00% | 0.00% | - | - | - | - |
| 395 | Power Operated Equipment | - | 0.00% | 0.00% | - | - | - | - |
| 396 | Communication Equipment | - | 0.00% | 0.00% | - | - | - | - |
| 397 | Miscellaneous Equipment | - | 0.00% | 0.00% | - | - | - | - |
| 398 | Other Tangible Plant | - | 0.00% | 0.00% | - | - | - | - |
| | Totals | | | | 7,582,336 | 0 | 751,099 | 7,892,199 |

*State basis used for percentages used in schedule.

| | | | | |
|---|---|---|----------------|----------------|
| Name of Respondent | | This Report is: | Date of Report | Year of Report |
| Tennessee Wastewater Systems, Inc. | | (1) <input checked="" type="checkbox"/> An Original | (Mo, Da, Yr) | |
| | | (2) <input type="checkbox"/> A Resubmission | 2/3/2017 | 41273 |
| SEWER OPERATION & MAINTENANCE EXPENSE | | | | N/A |
| Acct No. | Description (a) | Amount (b) | | |
| 701 | Salaries & Wages - Employees | 451,364 | | |
| 703 | Salaries & Wages - Officers, Directors & Stockholders | - | | |
| 704 | Employee Pensions & Benefits | 24,338 | | |
| 710 | Purchased Sewage Treatment | 107,924 | | |
| 711 | Sludge Removal Expense | - | | |
| 715 | Purchased Power | 132,977 | | |
| 716 | Fuel for Power Production | - | | |
| 718 | Chemicals | 3,882 | | |
| 720 | Materials & Supplies | 67,970 | | |
| 730 | Contractual Services | 341,477 | | |
| 740 | Rents | 60,945 | | |
| 750 | Transportation Expense | 67,541 | | |
| 755 | Insurance Expense | 17,744 | | |
| 765 | Regulatory Commission Expense | 10,284 | | |
| 770 | Bad Debt Expense | - | | |
| 775 | Miscellaneous Expenses | 449,189 | | |
| Total Sewer Operation & Maintenance Expense | | 1,725,435 | | |
| | | | | |

| | | | | |
|------------------------|-----------------------------------|------------------|-----------------------|---------------------------------|
| SEWER CUSTOMERS | | | | |
| Description (a) | Customers First of Year (b) | Additions (c) | Disconnections (d) | Customers End of Year (e) |
| Metered Customers: | | | | |
| 5/8 Inch | - | - | - | - |
| 3/4 Inch | - | - | - | - |
| 1.0 Inch | - | - | - | - |
| 1.5 Inch | - | - | - | - |
| 2.0 Inch | - | - | - | - |
| 2.5 Inch | - | - | - | - |
| 3.0 Inch | - | - | - | - |
| 4.0 Inch | - | - | - | - |
| 6.0 Inch | - | - | - | - |
| 8.0 Inch | - | - | - | - |
| Other (Please Specify) | - | - | - | - |
| Other (Please Specify) | - | - | - | - |
| Other (Please Specify) | - | - | - | - |
| Unmetered Customers | 2,746 | 129 | - | 2,875 |
| Total Customers | 2,746 | 129 | 0 | 2,875 |
| | | | | |

| | | | |
|---|--|---|--------------------------------|
| Name of Respondent Tennessee Wastewater Systems, Inc. | This Report is: (1) <u>X</u> An Original (2) A Resubmission | Date of Report (Mo, Da, Yr) 2/3/2017 | Year of Report 41273 |
|---|--|---|--------------------------------|

PUMPING EQUIPMENT

| Description*** (a) | Lift Station #1 (b) | Lift Station #2 (c) | Lift Station #3 (d) | Lift Station #4 (e) |
|-------------------------------------|--------------------------------------|--------------------------------------|--------------------------------------|--------------------------------------|
| Make, Model, or Type of Pump | | | | |
| Year Installed | | | | |
| Rated Capacity (GPM) | | | | |
| Size (HP) | | | | |
| Power (Electric/Mechanical) | | | | |
| Make, Model or Type of Motor | | | | |

SERVICE CONNECTIONS

| Description*** (a) | Service Connection #1 (b) | Service Connection #2 (c) | Service Connection #3 (d) | Service Connection #4 (e) |
|-------------------------------------|--|--|--|--|
| Size (Inches) | | | | |
| Type (PVC, VCP, etc) | | | | |
| Average Length (Feet) | | | | |
| Connections-Beginning of Year | - | - | - | - |
| Connections-Added during Year | - | - | - | - |
| Connection-Retired during Year | - | - | - | - |
| Connections-End of Year | 0 | 0 | 0 | 0 |
| Number of Inactive Connections | - | - | - | - |

COLLECTING MAINS, FORCE MAINS, & MANHOLES

| Description (a) | Collecting Mains (b) | Force Mains (c) | Manholes (d) |
|-----------------------------------|---------------------------------------|----------------------------------|-------------------------------|
| Size (Inches) | | | |
| Type | | | |
| Length/Number-Beginning of Year | - | - | - |
| Length/Number-Added During Year | - | - | - |
| Length/Number-Retired During Year | - | - | - |
| Length/Number-End of Year | 0 | 0 | 0 |

***If more space is needed to list equipment please attach additional sheets as necessary.

| | | | | | |
|--|--|---|--|--|--|
| Name of Respondent Tennessee Wastewater Systems, Inc. | | This Report is: (1) <u>X</u> An Original (2) A Resubmission | | Date of Report (Mo, Da, Yr) 2/3/2017 | Year of Report 41273 |
| TREATMENT PLANT | | | | | |
| Description*** (a) | | Treatment Facility #1 (b) | Treatment Facility #2 (c) | Treatment Facility #3 (d) | Treatment Facility #4 (e) |
| Manufacturer | | | | | |
| Type | | | | | |
| Steel or Concrete | | | | | |
| Total Capacity | | | | | |
| Average Daily Flow | | | | | |
| Effluent Disposal | | | | | |
| Total Gallons of Sewage Treated | | | | | |
| MASTER LIFT STATION PUMPS | | | | | |
| Description*** (a) | | Master Pump #1 (b) | Master Pump #2 (c) | Master Pump #3 (d) | Master Pump #4 (e) |
| Manufacturer | | | | | |
| Capacity (GPM) | | | | | |
| Size (HP) | | | | | |
| Power (Electric/Mechanical) | | | | | |
| Make, Model, or Type of Motor | | | | | |
| OTHER SEWER SYSTEM INFORMATION | | | | | |
| Present Number of Equivalent Residential Customer's * being served | | | | | |
| Maximum Number of Equivalent Residential Customer's * that the system can efficiently serve | | | | | |
| Estimated Annual Increase in Equivalent Residential Customers * | | | | | |
| * Equivalent Residential Customers = (Total Gallons Treated / 365 Days) / 275 Gallons Per Day. | | | | | |
| Total Gallons Treated includes both sewage treated and purchased sewage treatment. | | | | | |
| State any plans and estimated completion dates for any enlargements of this system: | | | | | |
| _____ | | | | | |
| _____ | | | | | |
| If the present systems do not meet environmental requirements, please submit the following: | | | | | |
| A. An evaluation of the present plant or plants in regard to meeting the requirements. | | | | | |
| B. Plans for funding and construction of the required upgrading. | | | | | |
| C. The date construction will begin. | | | | | |
| What is the percent of the certificated area that have service connections installed? | | | | | |
| _____ | | | | | |
| _____ | | | | | |

***If more space is needed to list equipment please attach additional sheets as necessary.

| Name of Respondent | This Report is: | Date of Report | Year of Report |
|---|--|--------------------------|----------------|
| Tennessee Wastewater Systems, Inc. | (1) <input checked="" type="checkbox"/> An Original (2) <input type="checkbox"/> A Resubmission | (Mo, Da, Yr) 2/3/2017 | 41273 |
| SUPPLEMENTAL FINANCIAL DATA TO THE ANNUAL REPORT | | | |
| Rate Base | | | |
| Additions: | | | |
| Plant In Service | | | |
| Construction Work in Progress | | | |
| Property Held For Future Use | | | |
| Materials & Supplies | | | |
| Working Capital Allowance | | | |
| Other Additions - Common Plant Alloc from Parent Company | | | |
| Other Additions (Please Specify) | | | |
| Total Additions to Rate Base | | | 0 |
| Deductions: | | | |
| Accumulated Depreciation | | | |
| Accumulated Deferred Income Taxes | | | |
| Pre 1971 Unamortized Investment Tax Credit | | | |
| Customer Deposits | | | |
| Contributions in Aid of Construction | | | |
| Other Deductions (Please Specify) | | | |
| Other Deductions (Please Specify) | | | |
| Total Deductions to Rate Base | | | 0 |
| Rate Base | | | 0 |
| Adjusted Net Operating Income | | | |
| Operating Revenues: | | | |
| Residential | | | |
| Commercial | | | |
| Industrial | | | |
| Public Authorities | | | |
| Multiple Family | | | |
| Fire Protection | | | |
| All Other | | | |
| Total Operating Revenues | | | 0 |
| Operating Expenses: | | | |
| Operation | | | |
| Depreciation | | | |
| Amortization | | | |
| Taxes Other Than Income Taxes | | | |
| Income Taxes | | | |
| Total Operating Expense | | | 0 |
| Net Operating Income | | | 0 |
| Other (Please Specify) | | | |
| Other (Please Specify) | | | |
| Adjusted Net Operating Income | | | 0 |
| Rate of Return (Line 49 / Line 25) | | | 0.00% |
| All amounts should be calculated in a manner consistent with the last Rate Order issued by the Commission for this Company. | | | |

| | |
|----------------|------------------------------------|
| Company Name: | Tennessee Wastewater Systems, Inc. |
| Report Period: | 31-Dec-16 |
| Report Date: | 2/3/2017 |

BALANCE SHEET:

| | Amount for 1st Reference | Amount for 2nd Reference | Difference |
|---|--------------------------------|--------------------------------|------------|
| 1. Line 10 on F4, col. "C" agrees w/line 16 on F5, col. "F". | 23,057,126 | 23,057,126 | 0 |
| 2. Line 10 on F4, col. "C" agrees w/lines 34, W1, col. "F" & 32, S1, col. "F" | 23,057,126 | 23,057,126 | 0 |
| 3. Line 11 on F4, col. "C" agrees w/line 52 on F5, col. "F". | 7,892,199 | 7,892,199 | 0 |
| 4. Line 11 on F4, col. "C" agrees w/lines 32, W2, col. I & 30, S2, col. I | 7,892,199 | 7,892,199 | 0 |
| 5. Line 27 on F4, col. "C" agrees w/line 10 on F6, col. "B". | 1,000 | 1,000 | 0 |
| 6. Line 28 on F4, col. "C" agrees w/line 10 on F6, col. "C". | - | - | 0 |
| 7. Line 30 on F4, col. "C" agrees w/line 24 on F6, cols. "B" & "C". | 346,557 | 346,557 | 0 |
| 8. Line 31 on F4, col. "C" agrees w/line 37 on F6, cols. "B" & "C". | - | - | 0 |
| 9. Line 37 on F4, col. "C" agrees w/line 55 on F6, col. "C". | - | - | 0 |
| 10. Line 41 on F4, col. "C" agrees w/line 32 on F7, col. "E". | - | - | 0 |
| 11. Line 48 on F4, col. "C" agrees w/line 13 on F8, col. "D". | 14,906,533 | 14,906,533 | 0 |
| 12. Line 8 on F8, col. "D" agrees w/line 55 on F8, cols. "C" & "D". | 1,136,075 | 1,136,075 | 0 |